

WasteMaid[®]

FOOD WASTE DISPOSERS *Elite*

1785_{BF}

Batch Feed



1/2 HP



BIO SHIELD (Antimicrobial) for **ODOR PROTECTION!**
Disposers are treated with an antimicrobial agent molded inside providing protection against odor causing bacteria growth.



THE **TORQUE MASTER** GRINDING SYSTEM is a combination of computer designed and balanced components working in unison to provide superior torque grind speed and long system life.

Batch Feed Disposer

The WASTEMAID ELITE batch feed disposer utilizes a stopper/actuator which makes operation safer and quieter and eliminates the need for an outside on/off switch.

Corrosion Proof

The WASTEMAID ELITE 1785-BF carries a lifetime warranty against failure due to corrosion.

Permanent Magnet Motors

WASTEMAID ELITE motors offer maximum torque instantly with the power to cut through potential jams.

Compact and Lightweight

The compact design of your WASTEMAID ELITE allows inclusion where limited under counter space is available.

SPECIFICATIONS

MODEL #1785-BF

HORSEPOWER	1/2 HP
MOTOR SPEED RPM	2600
VOLTAGE	220-240V
WATTAGE	475
AMPS	2.25
CYCLES	50/60
MOTOR TYPE	Permanent Magnet
DRAIN OUTLET	Polycarbonate 940
FEED	Batch Loading
WASTE ELBOW	ABS
GRIND RING	Stainless Steel
SWIVEL IMPELLERS	Stainless Steel
BALANCED TURNTABLE	Stainless Steel
HOPPER	ABS
DRAIN HOUSING	Thermoset Polymer
OVERLOAD PROTECTOR	Manual Reset Type
SINK FLANGE	Polyamide 66
STOPPER	Polycarbonate
BEARINGS	Permanently Lubricated, Sleeve Type
SOUND SHELL	Full
UNIT WEIGHT	5.6 KG
MEASUREMENT A	430 mm
MEASUREMENT B	233 mm
MEASUREMENT C	178 mm
MEASUREMENT D	137 mm
MEASUREMENT E	70 mm
LIFETIME CORROSION GUARANTEE	Yes

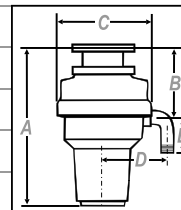

wastemaidshop.co.uk

All Waste Maid Elite Disposers are compliant with the EC Directive regards RoHS.